



Le Saint Martin
Camping ★★★★★

PRICES 2026

**DIRECT
ACCESS
TO THE BEACH**



OPEN FROM APRIL 1ST TO OCTOBER 11

9AM-7PM / JULY-AUGUST 9AM-7.45PM

0033 5 58 48 52 30

contact@camping-saint-martin.fr

2655, Avenue de l'Océan - 40660 MOLIETS-PLAGE

OUR BARS - RESTAURANTS - SHOPS

L'Endroit
LE SAINT-MARTIN
MOLIETS
ET SA PAILLOTE

05 58 49 69 38



SPAR



SUPERMARCHÉS
MESSANGES - MOLIETS

BOISSONS FRAÎCHES
BOUCHERIE - CHARCUTERIE
FRAIS SURGELÉS
PRESSE CARTES POSTALES
FRUITS & LÉGUMES

Faites vos courses en ligne
sur www.spar.fr

En juillet-août : ouverture non-stop 7J/7 - 7h30 à 21h00
Camping Le SAINT MARTIN - MOLIETS - 05 58 48 68 20

LUCAS
le gardien du goût

Boulangerie Pâtisserie Petites faims



TRAITEUR



PRODUITS
RÉGIONAUX

CAMPISTRON & GRIHON
LA TRADITION EST UN CHOIX

05 58 41 84 39

SHOPS

READY-MADE CLOTHES

 **MELISSA**
05 58 41 36 70

 **LA CABANE D'HUCHET**
Décoration d'intérieur
d'ici et d'ailleurs
Mobilier, accessoires, cadeaux...
06 22 37 73 35

Miss **MOLIETS**

CULTURE SUD
05 58 41 15 21



WELL-BEING

 * **martina**
coiffure
Sur rendez-vous
07.82.80.82.26
martina.coiffure@gmail.com
www.martina-coiffure.com

Relax Time
Forme & Bien-être

Massages et soins Ayurvédiques
Tous les jours sur rendez-vous
06 85 28 68 01

Pierre-Valentin
LABORDE-LAULHE

OSTEOPATHIE
Consultations sur RDV et urgences
ESPACE LE SAINT MARTIN

Ostéopathie du nourrisson à l'adulte,
sportifs, séniors, femmes enceintes
Prise en charge des consultations par les mutuelles

Paul-Loup
LABORDE-LAULHE

06 72 39 75 15

06 45 26 71 78



**SALON DE BEAUTÉ
& ONGLERIE**

Prendre rendez-vous :

Sur rendez-vous :

06 38 91 25 88



SURFSCHOOL

SURFSCHOOL - RENTAL

April to October on booking

+33 6 88 64 66 18

ecoledesurfdusaintmartin.fr

ecoledesurfdusaintmartin@gmail.com



THE LEISURE - ACTIVITIES

Le Saint Martin offers you:



Poney Walks

July and August

On Fridays

7€ the round



- 1 multi-sport area open from 9:00 am to 9:00 pm - 1 petanque court - 1 playground for children under parental supervision - table tennis tables - Trampolines (prices displayed on site)

LES MATINS ZEN

Campsite Observatory

YOGA & MEDITATION
with Catherine Boué



Tuesday, Thursday and Friday from 9 to 10 am
Booking Relax Times **06 85 28 68 01**

10 people max. Adults **7€**. Children free.



Every day (Saturday excluded), in July and August, a team of dynamic entertainers welcomes you for free activities for the whole family. The program is displayed and at your disposal in the reception office. *(Paying)



Kids and teens club



Entertainment for all



Trampoline*

PITCH PRICES

2 pers

Photos and texts are not contractually binding

OUR PRICES ARE FOR 1 NIGHT IN €, FROM, inclusive of VAT

THE PRICE INCLUDES:

1 marked pitch for 2 people with 1 tent, 1 caravan or 1 camper and 1 car or motorbike.



		LOW SEASON	MID SEASON	SEASON	HIGH SEASON	MID SEASON
		01/04 - 04/07 30/08 - 11/10	04/07 - 10/07	10/07 - 24/07	24/07 - 16/08	16/08 - 30/08
Pitches without electricity	80 - 100 m ²	19,00	39,60	59,70	62,70	43,00
Pitches with electricity (10A)	80 - 100 m ²	22,70	45,50	67,30	70,60	49,80
European sockets mandatory <i>(please bring extension lead + 25m)</i>	120 - 150 m ²	27,00	50,50	74,30	78,00	55,40
Pitches Grand Comfort	80 - 100 m ²	26,00	52,10	77,20	81,00	56,80
Electricity (1.5A) + water + used water European sockets mandatory <i>(please bring extension lead + 25m)</i>	120 - 150 m ²	30,30	57,10	83,40	87,50	61,80
Campétoile Tent <i>(2 pers max. with electricity)</i>		29,20	54,20	82,40	86,50	58,20

ADDITIONAL FEES	Low season 01/04-04/07 30/08-11/10	Mid Season Season 04/07-30/08
First Children under 13 years	OFFERED	
Additional person under 13 years	4,00 €/day	6,60 €/day
Additional person + 13 years	6,00 €/day	9,40 €/day
Additional car	OFFERED	6,60 €/day
Pet Up to date vaccination certificate obligatory and kept on the lead	4,00 €/day	7,00 €/day
European adapter	17,00 €	
Tourist tax (from 18 years old) (2025) <i>Subject to increase</i>	0,86 €/night	
Booking fees <i>*OFFERED in mid season and season if you book before the 1st of March.</i>	OFFERED	35,00 €*
Cancellation insurance Campez-Couvert coverage www.camping-saint-martin.fr	3,5% of the total cost of the stay when you book	

CAMPETOILE TENT

2 pers

- 1 room 2 pers.
- 1 terrace
- with electricity

This wood and canvas accommodation on stilts, with a sheltered eating area underneath and electricity supply, is perfect for walkers and cyclists. The upper terrace is reached via some stairs and you sleep on

a stretched canvas (please bring a sleeping bag or duvet). It can be rented for overnight stays (please see campsite prices).

For any further information, please refer to the enclosed General Terms and Conditions of Sale, or to www.camping-saint-martin.fr.

Photos and texts are not contractually binding



WATER FUN

Indoor and outdoor heated swimming pools. Indoor swimming pool with sauna and SPA, from the opening to the closing of the campsite. The outdoor pools will be partially open from mid-May and will be partially heated.



INFORMATIONS ABOUT RENTALS

Cotton sheets, blankets, pillows, heating and a safe are all included in the rates of our accommodations. The kitchen is fitted out with crockery, microwave, refrigerator, coffee machine, toaster...

DEPOSIT (credit card or cash)

At your arrival, at the time the keys are handed over to you, two deposits by credit card or cash, will be requested:

- 200 Euros for damaged accommodation
- 90 Euros for tents and chalets and 140 Euros for PREMIUM chalets for cleaning not done by you (including soiling and animal hair)

 Only 1 animal per accommodation is accepted with a fee payable at the time of booking (see rates).

They must be kept on a leash throughout the stay.

In the ACCOMMODATION, for reasons of hygiene and respect for the guests taking over, animals are not allowed in the rooms and the bathroom.

My master will think to take, in the suitcase, my basket to sleep: **the covers of the hiring are prohibited under penalty of additional invoicing.**

ON THE DAY OF DEPARTURE

On the day of departure, the accommodation must be vacated by 10 a.m. at the latest. It must be returned perfectly clean.

The appointment for the inventory shall be agreed with the Reception Office on the arrival of the customer (subject to the available scheduled hours).

PREMIUM CHALETs

- SPA * • Shower on the terrace* • Air conditioning
- plancha

BENEFITS

- TV included • A WIFI connection for one device*
- Cotton sheets provided, blankets / duvets / pillows • Hair dryer • Hair dryer End of rental cleaning fee (optional): 140€
- * depending on accommodation



ADDITIONAL FEES	Low season	Mid Season
	01/04-04/07 30/08-11/10	Season 04/07-30/08
Pet <i>Up to date vaccination certificate obligatory and kept on the lead</i>	7,00 €/day	8,50 €/day
Tourist tax (from 18 years old) (2025) <i>Subject to increase</i>	0,86 €/night	
Booking fees <i>*OFFERED in mid season and season if you book before the 1st of March.</i>	OFFERED	35,00 €*
Travel cot	2,00 €/day	
High-chair	2,00 €/day	
Bath kit (1 large towel + 1 small)	8,00 €/stay	
Cancellation insurance Campez-Couvert www.camping-saint-martin.fr	3,5% of the total cost of the stay when you book	
Cotton sheets	OFFERED	
Bath and booster seat - Changing mat	OFFERED	

For any further information, please refer to the enclosed General Terms and Conditions of Sale, or to www.camping-saint-martin.fr.

TELEVISION RENTAL

2 nights <i>3rd night free</i>	18 €
4 nights <i>5th night free</i>	27 €
6 nights <i>7th night free</i>	34 €
From 8 to 10 nights	42 €
more than 11 nights	45 €

COMMON SUPPLEMENTARY SERVICES

CANCELLATION INSURANCE

It is advisable to take out cancellation insurance: Our partner CampezCouvert. The cancellation insurance fee must be paid in full when you book your stay: it comes to 3,5% of the total cost of the stay.
(refer to the enclosed General Terms and Conditions of Sale)

Safety deposit box	3,00 €/day
Mini fridge	4,00 €/day
Washing machine	6,00 €
Clothes dryer	4,00 €
Visitors	adults 7,00 € children -13y 5,00 €

WIFI PRICE (PRICE BY CODE)

Code to be activated within 12 hours after printing the ticket.

OFFERED off-season and paid from 1st July to 31st August

Flat rate minute	30 min	60 min	120 min	Flat rate unlimited	1 day	2 days	4 days	7 days	14 days	1 month
	4€	7€	11€		8€	13€	17€	22€	33€	42€





PREMIUM / SPA

LUXURY CHALET - AIR CONDITIONER - SEA VIEW PRIVATE SPA

- 1 bedroom with double bed (160 cm)
- 1 bedroom with 2 beds (80 cm).
- 1 living room with sofa, air conditioning.
- 1 kitchenette with dishwasher. • 1 bathroom, hair-dryer, separate WC. • Large terrace, garden furniture, sun lounge / relax chair, plancha.
- Shower on the terrace • 1 Private SPA

HIGH SEASON
One week
PRICES

Renting
FROM SUNDAY TO SUNDAY.

21/06	28/06	05/07	12/07	19/07	26/07	02/08	16/08	23/08	30/08
28/06	05/07	12/07	19/07	26/07	02/08	16/08	23/08	30/08	06/09
1130	1880	2380	2630	2730	2900	3090	2660	1990	1060

AUTAN

4 pers

PRICES IN €, FROM, inclusive of VAT without tourist tax

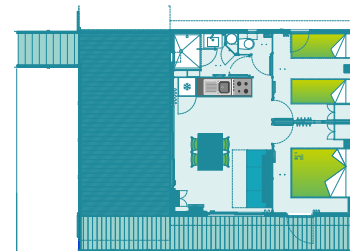

TV INCLUDED
1 FREE WIFI CONNECTION

2 Nights
3rd night FREE

4 Nights
5th night FREE

EASTERN

01/04 - 06/04

600

810

2 nights 3 nights 4 nights 5 nights 6 nights 7 nights 10 nights 12 nights 14 nights

LOW SEASON

06/04 - 21/06
06/09 - 11/10

320

475

620

750

865

970

1215

1380

1550

Photos and texts are not contractually binding



PREMIUM / SPA

LUXURY PREMIUM MOBILE HOME - AIR-CONDITIONED - PRIVATE SPA

- 1 bed room with double beds (160 cm)
- 1 bedroom with 2 beds (80 cm)
- 2 bathrooms, 1 hair dryer, 2 toilets
- 1 living room with air conditioning
- 1 kitchenette with dishwasher
- Terrace, garden furniture, sun lounge/relax chair, plancha
- 1 Private SPA, shower on the terrace

HIGH SEASON
One week
PRICES

Renting
FROM SUNDAY TO SUNDAY.

21/06	28/06	05/07	12/07	19/07	26/07	02/08	16/08	23/08	30/08
28/06	05/07	12/07	19/07	26/07	02/08	16/08	23/08	30/08	06/09
960	1420	2050	2230	2410	2650	2780	2360	1620	910

JORAN

4 pers

PRICES IN €, FROM, inclusive of VAT without tourist tax



TV INCLUDED
1 FREE WIFI CONNECTION

2 Nights
3rd night FREE

4 Nights
5th night FREE

EASTERN

01/04 - 06/04

490

650

2 nights 3 nights 4 nights 5 nights 6 nights 7 nights 10 nights 12 nights 14 nights

LOW SEASON

06/04 - 21/06
06/09 - 11/10

280

415

545

665

770

870

1090

1250

1400



PREMIUM / SPA

MALOJA

4 pers

PRICES IN €, FROM, inclusive of VAT without tourist tax



LUXURY CHALET PRIVATE SPA AND RELAX

- 1 bedroom with double bed (160 cm)
- 1 bedroom with 2 beds (80 cm).
- 1 living room with sofa, air conditioning.
- 1 kitchenette with dishwasher.
- 1 bathroom, hair-dryer, separate toilet.
- Large terrace, garden furniture, sun lounge/relax chair, plancha.
- Shower on the terrace • 1 Private SPA

TV INCLUDED

1 FREE WIFI CONNECTION

2 Nights

3rd night FREE

4 Nights

5th night FREE

EASTERN

01/04 - 06/04

490

680

2 nights 3 nights 4 nights 5 nights 6 nights 7 nights 10 nights 12 nights 14 nights

LOW SEASON

06/04 - 20/06
05/09 - 11/10

280

420

545

660

760

855

1080

1230

1390

HIGH SEASON

One week
PRICES

Renting

FROM SATURDAY TO SATURDAY.

20/06

27/06

970

27/06

04/07

1420

04/07

11/07

2060

11/07

18/07

2260

18/07

25/07

2420

25/07

01/08

2650

01/08

15/08

2800

15/08

22/08

2420

22/08

29/08

1690

29/08

05/09

930

Photos and texts are not contractually binding



PREMIUM / SPA

PAMPERO

4 pers

PRICES IN €, FROM, inclusive of VAT without tourist tax



CHALET - SOLARIUM SEA VIEW - PRIVATE SPA

- 1 room with double bed (160 cm).
- 1 room with beds (80 cm).
- 1 living-room, 1 kitchenette, air conditioning.
- 1 bathroom, WC.
- Terrace, garden furniture, sun lounge / relax chair, plancha.
- Solarium with panoramic view on the roof
- Shower on the terrace • 1 Private SPA

TV INCLUDED

1 FREE WIFI CONNECTION

2 Nights

3rd night FREE

4 Nights

5th night FREE

EASTERN

01/04 - 06/04

470

620

2 nights 3 nights 4 nights 5 nights 6 nights 7 nights 10 nights 12 nights 14 nights

LOW SEASON

06/04 - 22/06
07/09 - 11/10

280

415

535

640

740

825

1040

1180

1320

HIGH SEASON

One week
PRICES

Renting

FROM MONDAY TO MONDAY.

22/06

29/06

950

29/06

06/07

1400

06/07

13/07

2040

13/07

20/07

2210

20/07

27/07

2390

27/07

03/08

2620

03/08

17/08

2780

17/08

24/08

2300

24/08

30/08

1600

30/08

07/09

890



PREMIUM / SPA

LUXURY CHALET 2 FLOORS SEA VIEW

On the ground floor

- 1 bedroom with 2 beds (80 cm) • 1 living room with sofa
- 1 kitchenette with dishwasher • Bathroom, separate toilet

Upstairs

- 1 bedroom with air conditioner double bed (160 cm)
- 1 Solarium • Terrace, garden furniture, sun lounger / relax chair, plancha • 1 Private SPA

HIGH SEASON

One week
PRICES

Renting

FROM SATURDAY TO SATURDAY.

20/06
27/06

1070

Océan & SPA

4 pers

PRICES IN €, FROM,
inclusive of VAT without tourist tax



TV INCLUDED
1 FREE WIFI CONNECTION

2 Nights
3rd night FREE

4 Nights
5th night FREE

EASTERN

01/04 - 06/04

530

720



LOW SEASON

06/04 - 20/06
05/09 - 11/10

2 nights 3 nights 4 nights 5 nights 6 nights 7 nights 10 nights 12 nights 14 nights

310

455

595

715

825

920

1160

1320

1490

27/06

1480

04/07

2250

11/07

2500

18/07

2610

25/07

2760

01/08

2950

15/08

2540

22/08

1800

29/08

1020

Photos and texts are not contractually binding



PREMIUM / SPA

LUXURY CHALET TERRACE / PRIVATE SPA

- 1 bedroom with double bed (160 cm).
- 1 bedroom with 2 beds (80 cm).
- 1 bedroom with 1 bed (80 cm).
- 1 living room, kitchenette with dishwasher, air conditioning.
- 2 bathrooms, 1 hair dryer, 2 toilets.
- terrace, garden furniture, sun lounger / relax chair, plancha.
- Shower on the terrace • 1 Private SPA

HIGH SEASON

One week
PRICES

Renting

FROM SATURDAY TO SATURDAY.

20/06
27/06

1320

27/06

1600

04/07

2360

11/07

2650

18/07

2730

25/07

3060

01/08

3290

15/08

2950

22/08

2020

29/08

1000

SONORA

5 pers

PRICES IN €, FROM,
inclusive of VAT without tourist tax



TV INCLUDED
1 FREE WIFI CONNECTION

2 Nights
3rd night FREE

4 Nights
5th night FREE

EASTERN

01/04 - 06/04

550

750



LOW SEASON

06/04 - 20/06
05/09 - 11/10

2 nights 3 nights 4 nights 5 nights 6 nights 7 nights 10 nights 12 nights 14 nights

340

480

610

720

825

910

1160

1320

1490



GARBIN

6 pers

PRICES IN €, FROM, inclusive of VAT without tourist tax



LUXURY MOBILE HOME - AIR-CONDITIONED - PRIVATE SPA

- 1 double bedroom (160 cm)
- 2 bedrooms with 2 beds (80 cm)
- 2 bathrooms, 1 hair-dryer • 2 WC
- 1 living room with sofa • Air conditioning
- 1 kitchenette with dishwasher
- Covered terrace, garden furniture, relax, plancha
- Shower on the terrace • 1 Private SPA

TV INCLUDED
1 FREE WIFI CONNECTION

2 Nights 4 Nights
3rd night FREE 5th night FREE

EASTERN 01/04 - 06/04

600 800

LOW SEASON 06/04 - 21/06
06/09 - 11/10

2 nights 3 nights 4 nights 5 nights 6 nights 7 nights 10 nights 12 nights 14 nights

360 505 640 760 870 970 1220 1390 1560

HIGH SEASON

One week
PRICES

Renting
FROM SUNDAY TO SUNDAY.

21/06	28/06	05/07	12/07	19/07	26/07	02/08	16/08	23/08	30/08
28/06	05/07	12/07	19/07	26/07	02/08	16/08	23/08	30/08	06/09
1340	1620	2460	2800	2960	3140	3340	3030	2100	1060

Photos and texts are not contractually binding



SKIRON

6 pers

PRICES IN €, FROM, inclusive of VAT without tourist tax



LUXURY CHALET TERRACE / PRIVATE SPA

- 1 bedroom with double bed (160 cm).
- 1 bedroom with 2 beds (80 cm).
- 1 bedroom with 2 beds (80 cm).
- 1 living room, kitchenette with dishwasher, air conditioning.
- 2 bathrooms, 1 hair dryer, 2 toilets.
- Terrace, garden furniture, sun lounger / relax chair, plancha.
- Shower on the terrace • 1 Private SPA

TV INCLUDED
2 FREE WIFI CONNECTIONS

2 Nights 4 Nights
3rd night FREE 5th night FREE

EASTERN 01/04 - 06/04

610 820

LOW SEASON 06/04 - 22/06
07/09 - 11/10

2 nights 3 nights 4 nights 5 nights 6 nights 7 nights 10 nights 12 nights 14 nights

360 510 650 770 885 990 1260 1430 1610

HIGH SEASON

One week
PRICES

Renting
FROM MONDAY TO MONDAY.

22/06	29/06	06/07	13/07	20/07	27/07	03/08	17/08	24/08	30/08
29/06	06/07	13/07	20/07	27/07	03/08	17/08	24/08	30/08	07/09
1360	1680	2570	2880	2970	3140	3370	3080	2190	1080



PREMIUM / SPA

A 6 PERSON MOBILE HOME AND A SUITE (2 PERS) JOINED BY A TERRACE - PRIVATE SPA

In two modules:

- 2 bedrooms with double beds (160 cm) • 1 bedroom with 2 beds (80 cm).
- 1 bedroom with 2 bunk beds (80 cm).
- 3 bathrooms, 2 hair dryers, 3 toilets.
- 2 living rooms, 1 kitchenette, kitchenette with dishwasher, air conditioning.
- terrace, garden furniture, sun lounger / relax chair, plancha.
- Shower on the terrace • 1 Private SPA

HIGH SEASON

One week
PRICES

Renting
FROM SUNDAY TO SUNDAY.
FROM MONDAY TO MONDAY.

21/06-28/06	28/06-05/07	05/07-12/07	12/07-19/07	19/07-26/07	26/07-02/08	02/08-16/08	16/08-23/08	23/08-30/08	30/08-06/09
22/06-29/06	29/06-06/07	06/07-13/07	13/07-20/07	20/07-27/07	27/07-03/08	03/08-17/08	17/08-24/08	24/08-31/08	31/08-07/09
1825	2300	3340	3670	3910	4350	4620	3780	2930	1680

KUBAN

8 pers (6 + 2)

PRICES IN €, FROM,
inclusive of VAT without tourist tax



TV INCLUDED
2 FREE WIFI CONNECTIONS

2 Nights
3rd night FREE

4 Nights
5th night FREE

EASTERN

01/04 - 06/04

800

1170

2 nights 3 nights 4 nights 5 nights 6 nights 7 nights 10 nights 12 nights 14 nights

LOW SEASON

06/04 - 21/06
07/09 - 11/10

505

750

975

1175

1360

1520

1930

2200

2460

Photos and texts are not contractually binding



PREMIUM / SPA

2 MOBILE HOMES OF 4 PERSONS EACH JOINED BY AN TERRACE - PRIVATE SPA

In two modules:

- 2 bed rooms with double beds (160 cm)
- 2 bedrooms with 2 beds (80 cm)
- 4 bathrooms, 2 hair dryers, 4 toilets.
- 2 living rooms, 2 kitchenettes with dishwasher, air conditioning.
- Terrace, garden furniture, sun lounger / relax chair, plancha.
- Shower on the terrace • 1 Private SPA

HIGH SEASON

One week
PRICES

Renting
FROM SATURDAY TO SATURDAY.
FROM SUNDAY TO SUNDAY.

20/06-27/06	27/06-04/07	04/07-11/07	11/07-18/07	18/07-25/07	25/07-01/08	01/08-15/08	15/08-22/08	22/08-29/08	29/08-05/09
21/06-28/06	28/06-05/07	05/07-12/07	12/07-19/07	19/07-26/07	26/07-02/08	02/08-16/08	16/08-23/08	23/08-30/08	30/08-06/09
1890	2380	3480	3880	4240	4600	4850	4080	2940	1740

AQUILLON

8 pers (4 + 4)

PRICES IN €, FROM,
inclusive of VAT without tourist tax



TV INCLUDED
2 FREE WIFI CONNECTIONS

2 Nights
3rd night FREE

4 Nights
5th night FREE

EASTERN

01/04 - 06/04

820

1180

2 nights 3 nights 4 nights 5 nights 6 nights 7 nights 10 nights 12 nights 14 nights

LOW SEASON

06/04 - 20/06
06/09 - 11/10

530

780

1010

1215

1405

1580

2010

2280

2560

Gamme Glamping



SHAMAL TENT

4 pers

PRICES IN €, FROM, inclusive of VAT without tourist tax

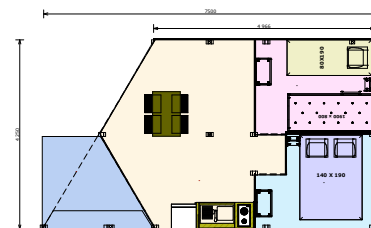

EQUIPPED TENT

- 1 room with double bed (140 cm)
- 1 room 2 beds (80 cm)
- 1 living-room with 1 kitchenette
- 1 terrace with garden furniture

2 nights 3 nights 4 nights 5 nights 6 nights 7 nights 10 nights 12 nights 14 nights

LOW SEASON	06/04 - 21/06		06/09 - 11/10										
	75	110	145	175	195	230	285	320	355				

HIGH SEASON

One week PRICES

Renting FROM SUNDAY TO SUNDAY.

21/06	28/06	05/07	12/07	19/07	26/07	02/08	16/08	23/08	30/08		
28/06	05/07	12/07	19/07	26/07	02/08	16/08	23/08	30/08	06/09		
290	450	770	940	1010	1050	1120	910	510	250		

Photos and texts are not contractually binding

Gamme Glamping



FAROU TENT

4 pers

PRICES IN €, FROM, inclusive of VAT without tourist tax

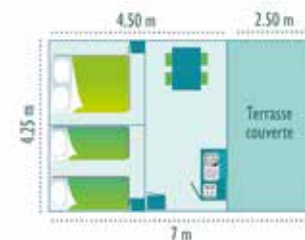

EQUIPPED TENT

- 1 room with double bed (140 cm)
- 1 room 2 beds (80 cm)
- 1 living-room with 1 kitchenette
- 1 terrace with garden furniture

2 nights 3 nights 4 nights 5 nights 6 nights 7 nights 10 nights 12 nights 14 nights

LOW SEASON	24/04 - 22/06		07/09 - 27/09										
	75	110	145	175	205	230	285	320	355				

HIGH SEASON

One week PRICES

Renting FROM MONDAY TO MONDAY.

22/06	29/06	06/07	13/07	20/07	27/07	03/08	17/08	24/08	30/08		
29/06	06/07	13/07	20/07	27/07	03/08	17/08	24/08	30/08	07/09		
290	490	820	940	1010	1050	1120	910	510	250		



MARIN

2 pers

PRICES IN €, FROM, inclusive of VAT without tourist tax



WOODEN FISHERMAN'S CABIN

- Studio with one double bed (160 cm)
- 1 kitchenette
- 1 bathroom, WC separated
- 1 terrace

Possibility to rent TV

2 Nights
3rd night FREE

4 Nights
5th night FREE

EASTERN

01/04 - 06/04

260

310

2 nights 3 nights 4 nights 5 nights 6 nights 7 nights 10 nights 12 nights 14 nights

LOW SEASON

06/04 - 21/06
06/09 - 11/10

165

205

245

280

315

335

420

480

540

HIGH SEASON

One week
PRICES

Renting

FROM SUNDAY TO SUNDAY.

21/06

28/06

450

28/06

05/07

690

05/07

12/07

885

12/07

19/07

970

19/07

26/07

1020

26/07

02/08

1080

02/08

16/08

1150

16/08

23/08

960

23/08

30/08

730

30/08

06/09

370

Photos and texts are not contractually binding



NOTUS

2 pers + 1 kid

PRICES IN €, FROM, inclusive of VAT without tourist tax



CHALET WITH COVERED TERRACE

- 1 room with a double bed (140 cm) + 1 bench bed
- 1 living-room with 1 kitchenette
- 1 bathroom, WC separated.
- 1 terrace with garden furniture

Possibility to rent TV

2 Nights
3rd night FREE

4 Nights
5th night FREE

EASTERN

01/04 - 06/04

200

270

2 nights 3 nights 4 nights 5 nights 6 nights 7 nights 10 nights 12 nights 14 nights

LOW SEASON

06/04 - 20/06
05/09 - 11/10

120

170

215

255

285

315

395

450

505

HIGH SEASON

One week
PRICES

Renting

FROM SATURDAY TO SATURDAY.

20/06

27/06

390

27/06

04/07

590

04/07

11/07

810

11/07

18/07

870

18/07

25/07

950

25/07

01/08

990

01/08

15/08

1040

15/08

22/08

870

22/08

29/08

640

29/08

05/09

340



SAMIEL

4 pers

PRICES IN €, FROM, inclusive of VAT without tourist tax



CHALET WITH COVERED TERRACE

- 1 room with double bed (140 cm)
- 1 room with beds (80 cm)
- 1 living-room, kitchenette
- 1 bathroom, WC
- 1 terrace with garden furniture and relax chair

Possibility to rent TV

EASTERN	01/04 - 06/04	2 Nights 3 rd night FREE		4 Nights 5 th night FREE	
		2P/3P	4P	270	320

LOW SEASON	06/04 - 20/06 06/09 - 11/10	2P/3P	2 nights	3 nights	4 nights	5 nights	6 nights	7 nights	10 nights	12 nights	14 nights
			160	200	240	280	310	335	425	485	545
		4P	200	260	320	370	420	465	580	665	740

HIGH SEASON

One week
PRICES

Renting

FROM SATURDAY TO SATURDAY.
FROM SUNDAY TO SUNDAY.

20/06-27/06	27/06-04/07	04/07-11/07	11/07-18/07	18/07-25/07	25/07-01/08	01/08-15/08	15/08-22/08	22/08-29/08	29/08-05/09
21/06-28/06	28/06-05/07	05/07-12/07	12/07-19/07	19/07-26/07	26/07-02/08	02/08-16/08	16/08-23/08	23/08-30/08	30/08-06/09
570	850	1200	1380	1550	1600	1680	1320	950	520

Photos and texts are not contractually binding



LA CABANE

4 pers

PRICES IN €, FROM, inclusive of VAT without tourist tax



CHALET WOOD ON STILTS SEA VIEW

- 1 room with double bed (140 cm) • 1 room with 2 beds (80 cm)
- 1 living-room with a sofa
- 1 kitchenette with a dishwasher
- 1 bathroom, WC separated
- 1 panoramic terrace with garden furniture and relax chair

Possibility to rent TV

EASTERN	01/04 - 06/04	2 Nights 3 rd night FREE		4 Nights 5 th night FREE	
		400	500		

LOW SEASON	06/04 - 22/06 07/09 - 11/10	2 nights	3 nights	4 nights	5 nights	6 nights	7 nights	10 nights	12 nights	14 nights
		260	345	430	500	570	630	790	900	1010

HIGH SEASON

One week
PRICES

Renting

FROM MONDAY TO MONDAY.

22/06	29/06	06/07	13/07	20/07	27/07	03/08	17/08	24/08	30/08
29/06	06/07	13/07	20/07	27/07	03/08	17/08	24/08	30/08	07/09
715	1050	1580	1740	1870	1960	1990	1610	1170	690



HEGOA

4 pers

PRICES IN €, FROM, inclusive of VAT without tourist tax

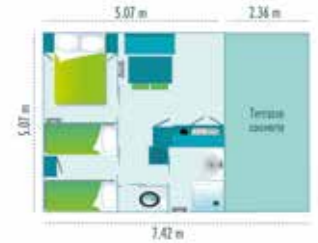

CHALET WITH COVERED TERRACE

- 1 room with double bed (140 cm)
- 1 room with beds (80 cm)
- 1 living-room, kitchenette
- 1 bathroom, WC
- 1 terrace with garden furniture and relax chair

Possibility to rent TV

2 Nights
3rd night FREE

4 Nights
5th night FREE

EASTERN	01/04 - 06/04	2P/3P	240	310
		4P	300	440

HIGH SEASON

One week
PRICES

Renting
FROM MONDAY TO MONDAY.

LOW SEASON	06/04 - 22/06 07/09 - 11/10	2P/3P	145	185	225	265	295	320	400	460	515
		4P	175	240	300	350	400	430	550	630	710

22/06	29/06	06/07	13/07	20/07	27/07	03/08	17/08	24/08	30/08
29/06	06/07	13/07	20/07	27/07	03/08	17/08	24/08	30/08	07/09
525	770	1120	1250	1360	1430	1560	1200	880	480

Photos and texts are not contractually binding



PONANT

4 pers

PRICES IN €, FROM, inclusive of VAT without tourist tax



MOBILE HOME

- 1 bedroom with double bed (140 cm).
- 1 bedroom with 2 beds (80 cm).
- 1 living room with kitchenette.
- 1 bathroom, WC
- 1 terrace and garden furniture.

Television available for hire.

Possibility to rent TV

2 Nights
3rd night FREE

4 Nights
5th night FREE

EASTERN	01/04 - 06/04	300	440
---------	---------------	-----	-----

HIGH SEASON

One week
PRICES

Renting
FROM SUNDAY TO SUNDAY.

LOW SEASON	06/04 - 21/06 06/09 - 11/10	175	240	300	350	400	430	550	630	710
		21/06	28/06	05/07	12/07	19/07	26/07	02/08	16/08	23/08
28/06	05/07	12/07	19/07	26/07	02/08	16/08	23/08	30/08	06/09	
490	750	1100	1250	1390	1450	1570	1220	900	500	



ALIZÉ

5 pers

PRICES IN €, FROM, inclusive of VAT without tourist tax

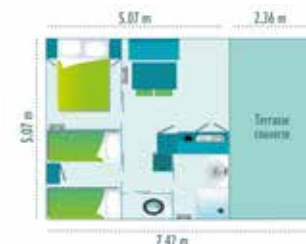

CHALET WITH COVERED TERRACE

- 1 room with double bed (140 cm)
- 1 room 3 beds (1 bunk bed) (80 cm)
- 1 living-room with kitchenette
- 1 bathroom, WC separated
- 1 terrace with garden furniture and relax chair

Possibility to rent TV
(depending on chalet)

2 Nights 4 Nights
3rd night FREE 5th night FREE

EASTERN	01/04 - 06/04	2P/3P	250	310
		4P/5P	310	450

LOW SEASON	21/04 - 23/06 08/09 - 11/10	2P/3P 4P/5P	2 nights	3 nights	4 nights	5 nights	6 nights	7 nights	10 nights	12 nights	14 nights
			160	205	245	275	305	335	420	480	535
			210	270	330	385	435	475	595	680	760

HIGH SEASON

One week
PRICES

Renting
FROM SATURDAY TO SATURDAY
FROM MONDAY TO MONDAY.

20/06-27/06	27/06-04/07	04/07-11/07	11/07-18/07	18/07-25/07	25/07-01/08	01/08-15/08	15/08-22/08	22/08-29/08	29/08-05/09
22/06-29/06	29/06-06/07	06/07-13/07	13/07-20/07	20/07-27/07	27/07-03/08	03/08-17/08	17/08-24/08	24/08-30/08	30/08-07/09
570	860	1150	1450	1560	1630	1740	1360	960	530

Photos and texts are not contractually binding



ZEPHYR

5 pers

PRICES IN €, FROM, inclusive of VAT without tourist tax



CHALET WITH COVERED TERRACE

- 1 room with a double bed (140 cm) • 1 room with 2 bunk beds (80 cm) and 1 truckle bed (70 cm) together 1 double bed
- 1 living-room.
- 1 kitchenette with a dishwasher
- 1 bathroom, WC separated.
- 1 terrace with garden furniture and relax chair

Possibility to rent TV

2 Nights 4 Nights
3rd night FREE 5th night FREE

EASTERN	01/04 - 06/04	350	470
----------------	---------------	-----	-----

LOW SEASON	06/04 - 21/06 06/09 - 11/10	2 nights	3 nights	4 nights	5 nights	6 nights	7 nights	10 nights	12 nights	14 nights
		220	280	335	385	435	470	590	675	760

HIGH SEASON

One week
PRICES

Renting
FROM SUNDAY TO SUNDAY.

21/06	28/06	05/07	12/07	19/07	26/07	02/08	16/08	23/08	30/08
28/06	05/07	12/07	19/07	26/07	02/08	16/08	23/08	30/08	06/09
570	870	1150	1460	1650	1730	1820	1390	970	530



BORA

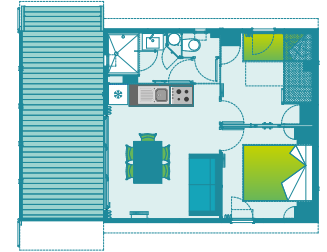

CHALET WITH COVERED TERRACE

- 1 room with a double bed (160 cm) • 1 room with 2 bunk beds (80 cm) and 1 truckle bed (70 cm) together 1 double bed
- 1 living-room.
- 1 kitchenette with a dishwasher
- 1 bathroom, WC separated.
- 1 terrace with garden furniture and relax chair

Possibility to rent TV

2 Nights
3rd night FREE

4 Nights
5th night FREE

EASTERN 01/04 - 06/04

360

480

LOW SEASON

06/04 - 22/06
07/09 - 11/10

2 nights 3 nights 4 nights 5 nights 6 nights 7 nights 10 nights 12 nights 14 nights

240 310 370 430 480 525 660 750 840

HIGH SEASON

One week
PRICES

Renting
FROM MONDAY TO MONDAY.

22/06

29/06

640

29/06

06/07

900

06/07

13/07

1470

13/07

20/07

1640

20/07

27/07

1780

27/07

03/08

1890

03/08

17/08

1990

17/08

24/08

1560

24/08

30/08

1050

30/08

07/09

570

Photos and texts are not contractually binding



CHERGUI

5 pers

PRICES IN €, FROM,
inclusive of VAT without tourist tax



CHALET WITH COVERED TERRACE

- 1 room with a double bed (160 cm) • 1 room with 2 bunk beds (80 cm) and 1 truckle bed (70 cm) together 1 double bed
- 1 living-room.
- 1 kitchenette with a dishwasher
- 1 bathroom, WC separated.
- 1 terrace with garden furniture and relax chair

Possibility to rent TV

2 Nights
3rd night FREE

4 Nights
5th night FREE

EASTERN 01/04 - 06/04

360

480

LOW SEASON

06/04 - 21/06
06/09 - 11/10

2 nights 3 nights 4 nights 5 nights 6 nights 7 nights 10 nights 12 nights 14 nights

240 310 370 430 480 525 660 750 840

HIGH SEASON

One week
PRICES

Renting
FROM SUNDAY TO SUNDAY.

21/06

28/06

640

28/06

05/07

900

05/07

12/07

1470

12/07

19/07

1640

19/07

26/07

1810

26/07

02/08

1890

02/08

16/08

1990

16/08

23/08

1560

23/08

30/08

1050

30/08

06/09

570



SIROCCO

5 pers

PRICES IN €, FROM, inclusive of VAT without tourist tax

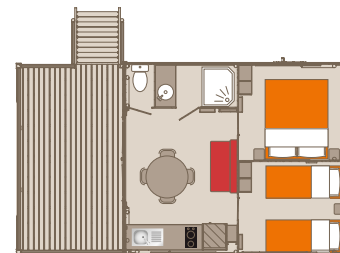

CHALET WOOD ON STILTS

- 1 room with double bed (140 cm)
- 1 room 3 beds (2 bunk beds) (80 cm)
- 1 living-room with 1 kitchenette
- 1 bathroom, WC separated
- 1 terrace and garden furniture.

Possibility to rent TV

		2 Nights 3 rd night FREE	4 Nights 5 th night FREE
EASTERN	01/04 - 06/04	2P/3P 240	310
		4P/5P 350	460

LOW SEASON	06/04 - 20/06 05/09 - 11/10	2P/3P 4P/5P	2 nights	3 nights	4 nights	5 nights	6 nights	7 nights	10 nights	12 nights	14 nights	
			20/06 27/06	04/07 11/07	11/07 18/07	18/07 25/07	25/07 01/08	01/08 15/08	15/08 22/08	22/08 29/08	29/08 05/09	
HIGH SEASON	Renting FROM SATURDAY TO SATURDAY.		620	800	1410	1610	1680	1790	1540	1490	990	540

HIGH SEASON

One week
PRICES

Renting

FROM SATURDAY TO SATURDAY.

Photos and texts are not contractually binding



NEW 2026

FOEHN

6 pers

PRICES IN €, FROM, inclusive of VAT without tourist tax



MOBILE HOME

- 1 bedroom with double bed (140 cm).
- 2 bedrooms with 2 beds (80 cm).
- 1 living room with kitchenette.
- 1 bathroom, WC separated
- 1 terrace and garden furniture.

Possibility to rent TV

		2 Nights 3 rd night FREE	4 Nights 5 th night FREE
EASTERN	01/04 - 06/04	370	500

LOW SEASON	06/04 - 21/06 06/09 - 11/10	2P/3P 4P/5P	2 nights	3 nights	4 nights	5 nights	6 nights	7 nights	10 nights	12 nights	14 nights	
			21/06 28/06	28/06 05/07	05/07 12/07	12/07 19/07	19/07 26/07	26/07 02/08	02/08 16/08	16/08 23/08	23/08 30/08	30/08 06/09
HIGH SEASON	Renting FROM SUNDAY TO SUNDAY.		620	920	1450	1700	1830	1920	2000	1620	1060	600

Television available for hire.

HIGH SEASON

One week
PRICES

Renting

FROM SUNDAY TO SUNDAY.



TIVANO

6 pers

PRICES IN €, FROM, inclusive of VAT without tourist tax

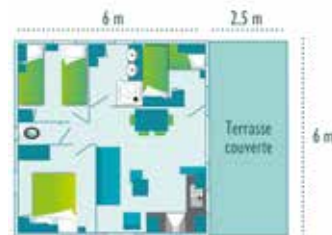

CHALET WITH COVERED TERRACE

- 1 room with a double bed (140 cm)
- 1 room with 2 beds (80 cm)
- 1 room with 2 bunk beds (80 cm)
- 1 living-room with kitchenette and dishwasher
- 1 bathroom, WC separated
- 1 terrace with garden furniture and relax chair

Possibility to rent TV

2 Nights
3rd night FREE

4 Nights
5th night FREE

EASTERN 01/04 - 06/04

430 **520**

2 nights 3 nights 4 nights 5 nights 6 nights 7 nights 10 nights 12 nights 14 nights

LOW SEASON 06/04 - 20/06
06/09 - 11/10

260 **340** **415** **485** **550** **600** **750** **860** **960**

HIGH SEASON

One week
PRICES

Renting

FROM SATURDAY TO SATURDAY.
FROM SUNDAY TO SUNDAY.

20/06-27/06	27/06-04/07	04/07-11/07	11/07-18/07	18/07-25/07	25/07-01/08	01/08-15/08	15/08-22/08	22/08-29/08	29/08-05/09
21/06-28/06	28/06-05/07	05/07-12/07	12/07-19/07	19/07-26/07	26/07-02/08	02/08-16/08	16/08-23/08	23/08-30/08	30/08-06/09
710	1080	1600	1810	1910	2000	2100	1860	1150	660

Photos and texts are not contractually binding



SUROUAS

6 pers

PRICES IN €, FROM, inclusive of VAT without tourist tax



CHALET WITH COVERED TERRACE

- 1 room with double bed (140 cm)
- 2 rooms with 2 beds (80 cm)
- 1 living-room with kitchenette and dishwasher
- 1 bathroom, WC separated
- 1 terrace with garden furniture and relax chair

Possibility to rent TV

2 Nights
3rd night FREE

4 Nights
5th night FREE

EASTERN 01/04 - 06/04

370 **500**

2 nights 3 nights 4 nights 5 nights 6 nights 7 nights 10 nights 12 nights 14 nights

LOW SEASON 06/04 - 22/06
07/09 - 11/10

230 **300** **370** **430** **485** **530** **670** **760** **860**

HIGH SEASON

One week
PRICES

Renting

FROM MONDAY TO MONDAY.

22/06	29/06	06/07	13/07	20/07	27/07	03/08	17/08	24/08	30/08
29/06	06/07	13/07	20/07	27/07	03/08	17/08	24/08	30/08	07/09
640	950	1470	1700	1830	1910	2010	1620	1070	580

PREMIUM



AURISSE

6 pers

PRICES IN €, FROM, inclusive of VAT without tourist tax



LUXURY MOBILE HOME «TAOS»

- 1 room with a double bed (160 cm)
- 1 room with 2 beds (80 cm)
- 1 room with 2 bunk beds (80 cm)
- Air conditioning
- 1 living-room, kitchenette with dishwasher
- 2 bathrooms, 1 hair dryer, 2 toilets.
- Terrace garden furniture, relax chair, plancha

TV INCLUDED
1 FREE WIFI CONNECTION

2 Nights 4 Nights
3rd night FREE 5th night FREE

EASTERN 01/04 - 06/04

450 550

LOW SEASON 06/04 - 20/06
05/09 - 11/10

2 nights 3 nights 4 nights 5 nights 6 nights 7 nights 10 nights 12 nights 14 nights

270 375 480 565 650 720 900 1030 1150

HIGH SEASON

One week
PRICES

Renting
FROM SATURDAY TO SATURDAY.

20/06	27/06	04/07	11/07	18/07	25/07	01/08	15/08	22/08	29/08
27/06	04/07	11/07	18/07	25/07	01/08	15/08	22/08	29/08	05/09
860	1200	1760	1990	2130	2260	2390	2100	1410	790

Photos and texts are not contractually binding

CLUBS, SPORT, ENTERTAINMENT FOR ALL

In July and August, free entertainment. A children's club, a teenagers' club and various activities are offered to you: volleyball tournaments, football, petanque competitions, aquagym and fitness classes, bingo, parties, concerts...



GENERAL TERMS AND CONDITIONS OF SALE

COMMON PROVISIONS

All bookings made for a stay at LE SAINT MARTIN campsite imply full acceptance of the present Terms and Conditions of Sale. Bookings will only take effect after receipt by the management of the booking form, duly completed and signed, or by acceptance of the General Terms and Conditions of Sale for on-line bookings. All bookings must be accompanied by a payment of 25% of the amount of the stay inclusive of VAT, as a down payment. Bookings take effect on receipt of the down payment, subject to availability. Customers will be sent a booking confirmation which they must present on arrival. All rentals are personal and may in no case be transferred.

All persons who have registered are required to comply with the provisions of the Campsite Rules available on request from reception.

Campsite access.

On arrival, the client must report to reception, where they will be given: one sticker per car – useful information for the stay – and one bracelet per occupant. Each occupant must wear their bracelet at all times during their stay. They undertake not to give it to anyone from outside the establishment. The latter provision is indispensable for the peace and quiet and the security of all guests.

If anyone should refuse to wear the bracelet, they will be refused access to the campsite and facilities.

LIABILITY INSURANCE:

It is the responsibility of residents to take out third-party risk insurance at their own expense. The service provider declines any responsibility in the event of the loss, theft or damage of any property belonging to the client, who remains solely responsible for all such property.

VISITORS:

It is possible to receive visitors inside the site. They must report to reception - give the name of the client and the number of the pitch or accommodation visited - and pay a fee (see price list) when they register. The campsite management reserves the right to refuse access to any unregistered visitors.

MINORS:

Minors may only stay with an adult - with a booking contract signed by a parent or legal guardian. –

ANIMALS:

1 single pet per pitch or accommodation shall be accepted inside the campsite for a fee that is payable at the time of booking. (See prices). Dogs of category 1 and 2 are strictly prohibited in the campsite.

It must be vaccinated and tattooed (an up-to-date vaccination card MUST be presented).

It must be kept on a leash.

In the accommodations, for the purposes of hygiene and consideration for other customers, pets are forbidden in the rooms and the toilets.

Animals are not allowed in the public areas including the animation - aquatic area - playground - FITNESS areas.

PRICES:

The Services offered by LE SAINT MARTIN are provided at the prices in force at the time of the order, as presented on the website www.camping-saintmartin.fr and at the reception. These prices are expressed in euros including VAT. Any discounts granted by LE SAINT MARTIN are specified with the prices. These rates are firm and non-revisable during the period of validity, as indicated on the website www.camping-saintmartin.fr and displayed at the reception or specified in the email or written proposal sent to the Customer. After this period of validity, the offer is void and LE SAINT MARTIN is no longer bound by the tariff.

ADMINISTRATIVE FEES:

Administrative fees of €35 will be charged on all accommodation or pitch bookings at the time of booking. No administrative fees will apply to stays in the OFF SEASON or for bookings for the SEASON made prior to 1st March. In the event of a booking cancellation, no administrative fees will be refunded.

TOURIST TAX:

The amount of tourist tax is not included in the price of the stay. It will be charged on top of the price (see price list).

PAYMENT:

All payments must be made out to: LE SAINT MARTIN for cheques, holiday vouchers.

We accept: Visa, Eurocard, Mastercard, American Express

Distance sales – Secure payment via Internet.

Bank transfers – Bank costs borne by the client.

WITHDRAWAL PERIOD:

In accordance with article L.221-28 of the French Consumer Code, the campsite informs its customers that the sale of accommodation services provided on a specific date, or according to a specific frequency, is not subject to the provisions relating to the 14-day withdrawal period. Consequently, the accommodation and leisure services ordered are exclusively subject to the cancellation conditions below.

CANCELLATION BY THE CLIENT

Any cancellation of a reservation or a stay must be notified by letter (registered letter with acknowledgment of receipt) to the campsite booking office - LE SAINT MARTIN – 2655 Avenue de l'Océan – 40660 MOUÏETS ET MAA.

No refunds will be given by the campsite LE SAINT MARTIN if holiday reservations are cancelled.

No refunds will be given if your holiday has started but has to be interrupted or cut short, especially due to late arrival, and for services that are not used as a result.

If you know you are going to arrive after the arrival date, you must inform the reservation department of LE SAINT MARTIN immediately. If not, the pitch or accommodation becomes vacant 24 hours after the arrival date mentioned in the contract. Any change in your reservation dates may mean you are allocated a different pitch from the one you originally booked.

CANCELLATIONS BY THE SERVICE PROVIDER:

Except in cases of force majeure for which due evidence must be supplied, in the event of a cancellation by the service provider, all sums already paid by the client will be refunded in full. This cancellation may in no case give rise to the payment of any damages. However, the service provider will make every possible effort to propose accommodation of an equivalent standard to that of the stay initially scheduled. The client will then have a period of 24 hours to accept or reject such changes. If the client should decide not to benefit from the alternative solution proposed, they may in no case claim any refund of the sums paid initially.

CANCELLATION/INTERRUPTION INSURANCE:

It is optional. However, it is advisable to take it out.

LE SAINT MARTIN campsite proposes cancellation/interruption insurance on your booking form or on the website www.camping-saintmartin.fr at the time of booking.

Our partner Grichen Affinity undertakes to refund all or part of the stay to customers who have taken out the «CampeZ Couvert» insurance policy. The insurance premium comes to 3.50% of the cost of the stay (excluding booking fees and tourist tax).

The cancellation insurance shall refund the amounts paid to LE SAINT MARTIN campsite, minus the booking fees of €35, the cancellation insurance fees, tourist taxes and the deductible of €15 provided for in the special conditions of CAMPEZ COUVERT.

The complete General Terms and Conditions are available on request at the campsite LE SAINT MARTIN or at www.campezcouvert.com

The cancellation insurance policy must be taken out when you book.

In the event of cancellation, inform the campsite LE SAINT MARTIN by letter or email as soon as the event preventing your departure occurs. If the claim is covered in the General Terms and Conditions (available at www.campezcouvert.com or from the campsite), inform the insurer within 48 hours and supply all necessary information and supporting documents.

If your stay is interrupted, pay for the full stay (the balance). Inform the campsite of your early departure.

Report your claim within 5 working days:

Online: www.campezcouvert.com/declarer-un-sinistre/

By email: sinistres@campezcouvert.com

By letter: CampeZ Couvert Grichen Affinity – Service Sinistre – CS70139 – 18021 BOURG-ES-CEDEX - FRANCE.

The cancellation policy and administrative fees are not refundable.

PITCH RENTALS:

Pitches must be booked in advance for stays in SEASON (see price list) for a minimum of 7 days, whatever the day of arrival.

The basic pitch comprises: 2 people, 1 tent or 1 caravan or 1 camping-car and a vehicle. (Beyond the number of persons included in the basic pitch, each additional person generates an additional charge (see rates)).

The campsite reserves the right to refuse access to groups or families with more than 6 people. All our pitches with ELECTRICITY and GRAND CONFORT are equipped with a connection with European outlets: be sure to bring a plug adapter and an extension cord of 25 meters.

Special offer for families: the first child under the age of 13 free of charge. Extra charge for each extra child after that.

Payment terms:

For bookings made over 30 days before the start date of the holiday, a deposit must be paid of 25% of the total price including taxes for the holiday at the time of booking, plus the booking fees and cancellation guarantee fees (if applicable). The balance must be paid no later than 30 days before the start date of the holiday at the campsite. For bookings made less than 30 days before the start date of the holiday, full payment for the holiday must be made at the time of booking. In the absence of full payment by the indicated date, the campsite reserves the right to cancel your reservation and retain the deposits already paid, as compensation for breach of contract without prior formal notice.

We reserve the right to make the corresponding services available for sale once again.

Arrival – Departure:

On the day of arrival, pitches are available from 2.30 pm and must be vacated and left clean before noon. Any overrun will be billed an additional day.

ACCOMMODATION

IN SAISON: bookings of rented accommodation are for a minimum of one week.

Days of arrival and departure are Saturday, Sunday or Monday, depending on the chalet, as specified in the price lists.

OUT OF SEASON: clients may make bookings for a minimum of 2 nights, and arrivals may be any day of the week.

Excess numbers: LE SAINT MARTIN campsite reserves the right to refuse access to groups or families with a number of participants exceeding the maximum number of people for each accommodation. This number is defined per category of accommodation. No over-occupancy will be tolerated.

Payment terms:

HOLIDAYS BOOKED FOR THE SEASON (dates indicated on our price schedule) before the 1st June: 25% of the price of the holiday at the time of booking plus the booking fees and cancellation guarantee fees (if applicable). For stays booked in SEASON, the balance is to be paid before June 1st.

Exceptionally, for all bookings made for the same period after June 1st, the entire holiday must be paid when it is booked.

HOLIDAYS BOOKED OUT OF SEASON

For OUT OF SEASON bookings (dates indicated on our price schedule), made over 30 days before the start date of the holiday, a deposit of 25% of the price for the reserved services must be paid at the time of booking.

The balance must be paid no later than 30 days before the start date of the holiday at the campsite.

For bookings made less than 30 days before the start date of the holiday, full payment of the holiday must be made at the time of booking.

In the absence of full payment by the indicated date, the campsite reserves the right to cancel your reservation and retain the deposits already paid, as compensation for breach of contract without prior formal notice.

We reserve the right to make the corresponding services available for sale once again.

Arrivals: Clients must report to reception, only from 5 pm onwards.

Sheets, pillow cases and blankets are provided and included in the price of the rental.

Keys to the accommodation will only be handed over to the client in return for the following two deposits:

- €200 for any damage there might be to the accommodation,
- €90 for cleaning of the tents and chalets and €140 for PREMIUM chalets if not done by the client before departure (including soiling and animal hair on blankets and all accommodation).

On arrival in the accommodation, the client should check its contents against the inventory

form provided in the chalet: any missing items or defects must be reported to reception on the day of arrival. No claims made at a later date will be accepted.

On the day of departure, on the day of departure, the accommodation must be vacated before 10 am. It must be left in a perfect state of cleanliness. The appointment for the inventory shall be agreed with the Reception Office on the arrival of the customer (subject to the available scheduled hours).

Any broken or damaged items will be replaced by the service provider at the expense of the client (see price list with the reception).

The above-mentioned deposit of €200 will only be returned to the client after payment of any costs and repairs that might be due to the service provider.

If the accommodation has not been cleaned by the customer before departure, the deposit of €90 or €140 for PREMIUM chalets will be kept by the service provider. Any problem in accommodation (stains and animal hair) on bedding and blankets will be subject to a billing of €90 or €140 in the same way as the household not performed.

PERSONAL DATA PROCESSING:

As part of the implementation of the European General Data Protection Regulation (GDPR), we have updated our Personal Data Protection Policy. The personal information collected on the www.camping-saintmartin.fr website is subject to secure computer processing for the exclusive use of the management of LE SAINT MARTIN campsite in the context of its commercial camping activity.

DATA COLLECTED:

The personal information we collect is gathered through forms and through the interactivity established between you and our website. We take care to collect only the personal data necessary for your stay, i.e. for all occupants and visitors: surname, first name, date of birth, and in addition for the holder of the reservation: address, email, telephone number and vehicle registration.

PURPOSE:

We use the information thus collected for the following purposes linked to the legitimate interests of LE SAINT MARTIN campsite and to comply with its legal and regulatory obligations:

- Prospecting
- Management of the relationship with customers and prospects
- Processing, execution, production, management, internal analysis and follow-up of reservations, requests and customer files, including payments.
- Prevention of money laundering and terrorist financing and combating corruption.
- Invoicing and accounting.

We do not pass your data to third parties, except where necessary and with your permission to sub-contractors.

DURATION:

Your personal data is kept for 3 years for quotation requests that have not given rise to a reservation, 10 years in other cases.

Access

You have the right to access, rectify or delete data concerning you.

You can address your questions and requests to our Data Protection Officer (DPO) Mr Jean-Christophe LARIE by e-mail dpo@camping-saintmartin.fr or by post LE SAINT MARTIN - 2655 avenue de l'Océan - 40660 MOUÏETS ET MAA

In addition, you may file any complaint with the CNIL.

COMPLAINTS

Any possible complaints concerning the non-conformity of the services compared to the contractual commitments may be notified by registered mail with acknowledgment of receipt to the manager of the campsite: LE SAINT MARTIN - 2655 avenue de l'Océan - 40660 MOUÏETS ET MAA

MEDIATION

In the event of a dispute and after informing the professional's customer service, any customer has the opportunity to refer to a consumer mediator, within a maximum of one year from the date of the written complaint sent to this professional by registered letter with acknowledgment of receipt.

The contact details of the mediator who may be contacted by the customer are as follows: BAYONNE MEDIATION - 32, rue de Hameau - 64 200 BIARRITZ or on the website www.bayonne-mediation.com

IMAGE RIGHTS

During your stay you may be filmed or photographed. We may use these photos or films for publicity purposes unless you inform reception in writing that you object to their use.

PHOTOS – PLANS FOR INFORMATION ONLY



Le Saint Martin

Camping ★★★★★



ACCESS



N10 dual carriageway, Bordeaux, Magescq then follow the signs for Léon and Moliets-Plage.
GPS coordinates: Latitude 43.85 - Longitude -1.38



TGV high-speed train Paris-Montparnasse - Dax (3h45) then bus from the station to Moliets.



Biarritz Airport (Ryanair, Transavia, Easy Jet, Air France). Pau (City Lisse Swiss, Ryanair, Air France).
Bordeaux-Mérignac (Ryanair, Easy Jet, Gerling US). Car hire.



www.camping-saint-martin.fr